



ELUNA Conference 2008



Renaissance Long Beach
111 East Ocean Boulevard
Long Beach, CA



Westin Long Beach
333 East Ocean Boulevard
Long Beach, CA

ELUNA Kick-Off Reception Tuesday, July 29th

Conference begins Wednesday, July 30th - Friday, August 1st

Hosted by California State University Office of the Chancellor
Funded by Registration Fees, ELUNA, and the Generous Support of Ex Libris and Sun Microsystems

ELUNA 2008 Program Planning Committee

Wil Frost, Chair	University of Hawaii at Manoa
Margery Tibbetts, Co-chair	California Digital Library
Marvin Pollard, Chair, Local Arrangements	California State University Office of the Chancellor
Roma Wallace, Local Arrangements	California State University Office of the Chancellor
Margie Battaglia, Coordinator, Internet Café	Boston College
Stephanie Brown, Chair, SFX Product Track	University of Connecticut
Pascal Calarco, Co-chair, DigiTool Product Track	University of Notre Dame
Edward Corrado, Liaison, Regional Users Groups	State University of New York - Binghamton
Elete Exline, Co-chair, DigiTool Product Track	University of New Hampshire
Katie Gohn, Co-coordinator, Evaluation	University System of Georgia
Laura Guy, Co-liaison, Special Interest Groups	Colorado School of Mines
Marcia Henry, Chair, MetaLib Product Track	California State University, Northridge
Donna Hirst, Coordinator, Conference Proceedings	University of Iowa
Nancy Hunter, Co-coordinator, Moderators	Colorado State University
Ellen Jones, Chair, ALEPH Product Track	University of Iowa
Sherrie Kristin, Co-chair, Voyager Product Track	Purdue University Calumet
Janet Lute, Vice-chair, Steering Committee (ex officio)	Princeton University
Chulin Meng, Chair, Posters Track	Loyola University Chicago
Christina Meyer, Chair, Steering Committee (ex officio)	University of Minnesota
Carole Pilkinton, Co-chair, Verde Product Track	University of Notre Dame
Dale Poulter, Chair, General Track	Vanderbilt University
Emily Prather, Co-coordinator, Moderators	North Central College
Habib Tabatabaia, Co-liaison, Special Interest Groups	University of Central Oklahoma
Antonella Ward, Co-coordinator, Evaluation	Angelo State University
Melissa Wisner, Co-chair, Voyager Product Track	Yale University
Amanda Yesilbas, Co-chair, Verde Product Track	University of Florida

ELUNA gratefully acknowledges the assistance of
Loralynne Evans, Conference Coordinator, Ex Libris

ELUNA Conference 2008 - Tuesday, July 29, 2008

1:00-6:00pm	Registration Desk Open (Westin Ocean Ballroom First Floor)
7:00-9:00pm	ELUNA Conference Reception (Aquarium of the Pacific) — see maps in this program

ELUNA Conference 2008 - Wednesday, July 30, 2008

7:30am-5:00pm	<i>Registration Desk Open</i> (Westin Ocean Ballroom 1st Floor)
7:30-8:45am	<i>Continental Breakfast</i> (Renaissance Ballroom Foyer Renaissance Naples 2 & 3 Westin Ocean Ballroom)
8:15-8:45am	<i>Presenter/Moderator Orientation</i> • Emily Prather & Nancy Hunter (Renaissance Naples 1)
9:00am thru Friday	<i>Posters on Display</i> (Westin Centennial Ballroom Prefunction)
9:00-10:30am	<i>General Session (Renaissance Ballroom)</i> <i>Welcome</i> • Wil Frost, Chair, Conference Planning Committee / <i>Greeting & Year in Review</i> • Chris Meyer, Chair, ELUNA / <i>Ex Libris Update</i> • Matti Shem Tov, President & Chief Executive Officer, Ex Libris; Robert Mercer, President, Ex Libris North America
10:30-11:00am	Break
11:00am-12:00pm	<i>Keynote Address: Information Flow in an Era of Networked Social Media</i> • Ms danah boyd (Renaissance Ballroom)
12:00-1:00pm	<i>ALEPH Demo</i> • Ex Libris (Westin Centennial Ballroom Foyer)
12:00-7:00pm	<i>Internet Café Open</i> (Westin Odessa)
12:30-2:00pm	Lunch (Westin Centennial Ballroom Salon A-B)
1:00-2:00pm	<i>Primo Demo</i> • Ex Libris (Westin Centennial Ballroom Foyer)
2:15-3:15pm	ALEPH 1. <i>ALEPH Product Group</i> • Betsy Friesen, Chair (Renaissance Sicilian B)
	2. <i>Lightening Round: ALEPH</i> (Renaissance Naples 1)
	DigiTool 3. <i>Lightening Round: DigiTool</i> (Renaissance Corsican)
	General 4. <i>Report of E-books Focus Group</i> • Christina Meyer & Kathryn Harnish (Westin Casablanca)
	MetaLib 5. <i>Lightening Round: MetaLib</i> (Renaissance Naples 3)
	Primo 6. <i>Lightening Round: Primo</i> (Westin Centennial Ballroom Salon D)
	Regional Groups 7. <i>All Regional Users Group Chairs Meeting</i> • Edward Corrado, Moderator; Loralynne Evans, Ex Libris (Renaissance Capri)
	SFX 8. <i>Lightening Round: SFX</i> (Renaissance Naples 2)
	Voyager 9. <i>Lightening Round: Voyager</i> (Renaissance Ballroom)
3:15-3:45pm	Break
3:45-5:15pm	<i>Ex Libris Strategic Direction</i> • Oren Beit-Arie, Chief Strategy Officer, Ex Libris (Renaissance Ballroom)
5:45-7:00pm	Primo 10. <i>Primo Product Group</i> • Jody Combs, Chair (Renaissance Sicilian B)
	11. <i>Ex Libris Mid-Atlantic Users Group (EMA)</i> - Delaware, New Jersey, New York, Eastern Pennsylvania (Renaissance Sicilian A)
	12. <i>Ex Libris South-Central Users Group (ELSUG)</i> - Arkansas, Kansas, Louisiana, Missouri, New Mexico, Oklahoma, Texas (Renaissance San Marco)
	13. <i>Ex Libris Southwest User Group (eSWUG)</i> - Arizona, California, Colorado, Nevada, New Mexico (Renaissance Sienna)
	Regional User Groups 14. <i>Georgia Users Group Meeting (GUGM)</i> - Georgia (Westin Barcelona)
	15. <i>Great Lakes Users Group (GLUG)</i> - Illinois, Indiana, Iowa, Michigan, Minnesota, Wisconsin; Ontario, Canada (Westin Shanghai)
	16. <i>Kentucky Voyager Users Group (KVUG)</i> - Kentucky (Westin Naples)
	17. <i>Northeast ExLibris User Group (NEVUG)</i> - Northeastern United States, Eastern provinces and territories of Canada (Renaissance Naples 1)
	18. <i>Northwest Region Northwest Endusers Group (NWEUG)</i> - Pacific Northwest (Westin Vancouver)
19. <i>Southeast Voyager Users Group Meeting (SEVUGM)</i> - Alabama, Florida, Georgia, Mississippi, North and South Carolina (Westin Tokyo)	

5:45-7:00pm	Regional User Groups	20. <i>Three Rivers Users Group (TREND)</i> - Ohio, Western Pennsylvania, West Virginia (Westin Melbourne)
		21. <i>Upper Midwest Ex Libris Users Group</i> - Iowa, Minnesota, North Dakota, South Dakota, Wisconsin (Renaissance Capri)
		22. <i>Washington DC Voyager Users Group (DC VUG)</i> - Maryland, Virginia, Washington, DC (Renaissance Corsican)
		23. <i>Western Canada Voyager Users Group (WCVUG)</i> - Alberta, British Columbia, Manitoba, Saskatchewan (Westin Casablanca)
	SFX	24. <i>SFX Product Group</i> • Karl Kocher, Chair (Renaissance Naples 2)
	Verde	25. <i>Verde Update</i> • Nettie Lagace, Ex Libris (Renaissance Naples 3)
7:00pm-		Dinner on Your Own

ELUNA Conference 2008 - Thursday, July 31, 2008

7:30-11:30am		<i>Registration Desk Open</i> (Westin Escalator Foyer 3rd Floor)
7:30-8:30am		<i>Continental Breakfast</i> (Renaissance Ballroom Foyer Westin Centennial Ballroom Prefunction)
All Day		<i>Posters on Display</i> (Westin Centennial Ballroom Prefunction)
7:30am-5:00pm		<i>Internet Café Open</i> (Westin Odessa)
8:30-10:00am	ALEPH	26. <i>ALEPH Update</i> • Jo Richardson, Ex Libris (Renaissance Naples 2)
	DigiTool	27. <i>DigiTool Product Group</i> • Eleta Exline, Chair (Renaissance San Marco)
	General	28. <i>How Secure Are Our Servers</i> • Sharon Yang, Meghan Weeks (Renaissance Corsican)
		29. <i>Fantasy Serials Module</i> • Michael Lampley, Nancy Gibbs (Renaissance Sienna)
		30. <i>E-book Access: Today and Tomorrow</i> • Julia McGinnis (Renaissance Naples 3)
		31. <i>Ex Libris Unified Resource Management (URM) Strategy Discussion Group</i> (Westin Centennial Ballroom Salon D)
	MetaLib	32. <i>MetaLib Product Group</i> • Ronda Rowe, Chair (Renaissance Naples 1)
	SFX/Verde	33.1. <i>Expanding the Reach of SFX: How to Choose and Build Custom Extensions for SFX</i> • Mark Dehmlow, Ben Heet (Renaissance Sicilian A)
33.2. <i>What Six Months Can Do for You</i> • Wendy Robertson, Rob Van Rennes (Renaissance Sicilian A)		
	Voyager	34. <i>Voyager Update</i> • Mike Dicus, Ex Libris (Renaissance Ballroom)
10:00-10:30am		Break
10:00-11:00am		<i>MetaLib Demo</i> • Ex Libris (Westin Centennial Ballroom Foyer)
10:30-11:30am	ALEPH	35. <i>Personal Information in a Social World: Balancing Patron Privacy with Personalized Services</i> • Jennifer Kuntz (Westin Melbourne)
		36. <i>I Went to Israel and All I Got Was This Stupid T-shirt: A Week in Jerusalem Participating in ALEPH Version 19 Collaborative Testing</i> • Christopher Rose, Daniel Cromwell (Westin Vancouver)
		37. <i>ALEPH: Ask the Experts</i> • Sandy Card, Nancy Gibbs, Bob Gerrity, Ellen Jones, Christine Moulen, Brenda Rutten, Scott Schumucker (Westin Shanghai)
	DigiTool	38. <i>Metadata Matters: Developing a University Best Practices Model</i> • Nancy Chaffin Hunter, Patricia Rettig, Shu Liu (Renaissance Sicilian A)
	SFX	39. <i>SFX Update</i> • Christine Stohn, Ex Libris (Renaissance Naples 2)
	Primo	40. <i>Usability Tests of Primo at Emory Libraries</i> • Selden Deemer, Lee Howard (Renaissance Naples 1)
	Special Interest Groups	41. <i>Large Research Libraries Special Interest Group</i> • Jim Corey, Chair (Renaissance Corsican)
		42. <i>MARCit Special Interest Group</i> • Natalia Lyandres, Chair (Renaissance Sienna)
43. <i>MetaLib X Server Special Interest Group</i> • David Walker, Chair (Renaissance Sicilian B)		
44. <i>Public User Interface Special Interest Group</i> • Brian Thompson, Chair (Westin Barcelona)		

10:30-11:30am	Verde	45. <i>Verde 2.0 in an Asymmetrical Consortial Environment: First Experience from Production</i> • Andreas Sabisch (Renaissance Corsican)
	Voyager	46. Voyager Product Group • Ellie Briscoe, Chair (Renaissance Naples 3)
		47. <i>Electronic Reserves: Accommodating the Millennial Student</i> • Erin Hughes, Irene Kuchta (Westin Centennial Ballroom Salon D)
		48.1. <i>No AJAX, No JAVA, No Problem! Customizing WebVoyage with Limited Programmer Resources</i> • Margaret Warren (Renaissance Ballroom 1)
		48.2. <i>WebVoyage with a Wrapper</i> • Michael Doran (Renaissance Ballroom 1)
		49. <i>Introduction to Self-developed Web ILS Data Accessing Interfaces</i> • Li Hongfei (Renaissance Capri)
11:00am-12:00pm		<i>DigiTool Demo</i> • Ex Libris (Westin Centennial Ballroom Foyer)
12:00-1:00pm		<i>Voyager Demo</i> • Ex Libris (Westin Centennial Ballroom Foyer)
12:00-1:30pm		Lunch (Westin Centennial Ballroom Salon A-B) with reserved tables for the smaller Special Interest Groups: <i>ALEPH ARC</i> • Heather Hessel, Chair / <i>ALEPH Data Representation</i> • Corinna Baksik, Chair / <i>E-books & Ex Libris' Application Suite (All Products)</i> • Pascal Calarco, Chair / <i>Meridian</i> • Janet Lute, Chair / <i>Theological Libraries</i> • Leland Deeds, Chair / <i>Voyager Health Sciences Libraries</i> • Stephanie Ferretti, Chair / <i>Voyager Law Libraries</i> • Ruth Patterson Funabiki, Chair / <i>Voyager Media Scheduling</i> • Irene Patrick, Chair
2:00-3:00pm		<i>Ex Libris Management Q&A (Renaissance Ballroom)</i> • Matti Shem Tov, President & Chief Executive Officer, Ex Libris; Robert Mercer, President, Ex Libris North America; Oren Beit-Arie, Chief Strategy Officer, Ex Libris; Don Muccino, Vice President Global Support, Ex Libris; Nancy Dushkin, Vice President Marketing, Ex Libris; Einat Zviran, Vice President Development, Ex Libris
3:00-3:30pm		Break
3:30-5:00pm	ALEPH	50.1. <i>Get a Room: The New Booking Feature as Implemented at McGill</i> • Heather Cai (Renaissance Corsican)
		50.2. <i>It's Just a Click Away: Using ALEPH Request for Cross-campus Document Delivery</i> • David Atkins, Maribeth Manoff, Michael Rogers, William Deleonardis, Pam Sedgwick-Barker (Renaissance Corsican)
		51. <i>A Haddock by Any Other Name (Authority) is NOT a Haddock: Implementing Version 18 Authority Control Functionality</i> • Sandy Card, Betsy Friesen, Allison Powers, Sue Julich (Renaissance Capri)
		52. <i>ALEPH ILL2: Conversion and Implementation</i> • Scott Schmucker (Westin Tokyo)
	DigiTool	53.1. <i>Bringing Up a Digital Library: Growing Pains and Painlessly</i> • Naomi Steinberger (Renaissance Sicilian B)
		53.2. <i>Wiki Start up Advice: Using a Wiki for Intra and Interdepartmental Communication</i> • Sarah Theimer (Renaissance Sicilian B)
		54.1. <i>Extending DigiTool Deposit for ETDs with Web Services</i> • Kerry Bouchard (Renaissance Sienna)
		54.2. <i>A Standardized DigiTool Ingest Approach to Internet Archive/Open Content Alliance Digitized Books</i> • Joseph Shubitowski, Leah Prescott (Renaissance Sienna)
	General	55. <i>Pros and Cons of Outsourcing Your Server: RITS Customers Share Their Experiences</i> • Ellie Briscoe, Marlene Caldwell, Don Muccino, Janice Christopher (Renaissance San Marco)
	MetaLib	56. <i>From Metasearch to Meta-services: Rethinking the Goals and Benefits of Metasearching Using the MetaLib X-server</i> • David Walker (Renaissance Naples 3)
	Primo	57. <i>Primo Update</i> • Gilad Gal, Ex Libris (Renaissance Naples 1)
	SFX/ MetaLib/ Verde	58.1. <i>Studying SFX Logs to Better Understand User Behavior</i> • Anne L. Highsmith, Bennett Claire Ponsford (Renaissance Naples 2)
		58.2. <i>Live Web Usability Lab</i> • Stephanie Willen Brown, Susan Teague Rector (Renaissance Naples 2)
		59. <i>Maintaining Availability: Ex Libris Applications Running on a RedHat Linux Cluster</i> • Tom Hanstra (Renaissance Sicilian A)
	Special Interest Groups	60. <i>ALEPH Acquisitions/Serials Special Interest Group</i> • Nancy Gibbs, Chair (Renaissance Sienna)
61. <i>ALEPH Circulation Special Interest Group</i> • Christopher Rose, Jennifer J. Kuntz, Co-chairs (Westin Shanghai)		
62. <i>Voyager Consortia/Consortia & Shared Systems Special Interest Groups</i> (joint meeting) • Kristine Hammerstrand & Pascal Calarco, Chairs (Westin Melbourne)		
63. <i>Voyager ILL Special Interest Group</i> • Antonella Ward, Chair (Westin Vancouver)		
Voyager	64. <i>What's Next in the Unicode Environment: Improving Access to Non-Roman Script Materials</i> • Ann Della Porta, David Bucknam (Westin Casablanca)	
	65.1. <i>Automating a Vendor File Load Process with Perl and Shell Scripting</i> • Roy Zimmer (Westin Barcelona)	
	65.2. <i>Perl DBI Scripting with the ILS</i> • Roy Zimmer (Westin Barcelona)	

3:30-5:00pm	Voyager	66. <i>The VuFind and Voyager Experience</i> • Birong Ho (Westin Centennial Ballroom Salon D) 67. <i>Who Needs Recall: Linking to ILL from the Catalog</i> • Dean Lingley, Noel Diaz, Sue Ward (Westin Naples)
5:00-6:00pm		Poster Sessions with presenters in attendance (Westin Centennial Ballroom Prefunction) <i>ALEPH v18 New Authority Control Setup and Testing</i> • Fang Peng, David Bolotine / <i>Across the Universe: the eSWUG Experience Hosting a Regional Training Event</i> • Margaret Driscoll, Robin Hartman, Nell Yang / <i>Batch Loading of Item Records from an Excel Spreadsheet</i> • Gwyneth Duncan / <i>Cataloging statistics using ALEPH and MistaT</i> • Selina Wang, Christine Moulen / <i>Chinese Wade-Giles to Pinyin Conversion With Aleph, GenLoad, and Connexion</i> • Yue Li, Dongqing Xie / <i>Developing a Persistent URL Creator for SFX</i> • Deborah Mouw / <i>"Don't Make Me Think": Re-designing "Save and Mail for Course Reserves" in ALEPH OPAC</i> • Heather Cai / <i>Documenting SFX at K-State Libraries; or, "You Should Blog That"</i> • Jamene Brooks-Kieffer / <i>Making Your ALEPH Web OPAC Accessible</i> • Dror Berger / <i>MetaLib X-Server Implementation @ CSUN: "Metasearch" to "Multisearch"</i> • Luiz Mendes, Coleen Martin, Marcia Henry / <i>A New Era in Information Service Delivery: Best Practices in Implementing ALEPH 500</i> • Sharon Premchand-Mohammed, Stella Sandy, Jennifer Joseph / <i>Preparations for Using p-manage-33 for Batch Record Deletion</i> • Steve R. Thomas / <i>Teaching SFX and Metalib to Inexperienced Users</i> • Linda Chenoweth / <i>Tuning Primo Stopwords</i> • Selden Deemer, Scott Turnbull / <i>Using Triggers to Capture Statistics in the Cataloging Module: An SQL Update</i> • Jason Fleming / <i>Yikes! How Many Databases Do I Need to Learn? Training the New Cataloger in a Multiple Database, Multiple Software Interface Environment</i> • Dianne Narum, Mary Ann Greenwald (No Host Cocktail Bar)
7:00-9:30pm		Cocktails & Conference Dinner (Renaissance Ballroom)

ELUNA Conference 2008 - Friday, August 1, 2008

7:30-9:00am		Registration Desk Open (Westin Escalator Foyer 3rd Floor)
7:30-8:30am		Continental Breakfast (Renaissance Ballroom Foyer Westin Centennial Ballroom Prefunction)
Until 3:30pm		Posters on Display (Westin Centennial Ballroom Prefunction)
7:30am-3:30pm		Internet Café Open (Westin Odessa)
8:30-9:30am		Breakfast with the Global Support Management Team (Renaissance Ballroom) - meet the North American support managers
8:30-10:00am	ALEPH	68.1. <i>ALEPH Course Reserves in Version 19: An Update from the ELUNA ALEPH Course Reserves Focus Group</i> • Christopher Rose, Ellen Jones, Kathy Isaacson, Leon Krauthausen, Fang Peng, Brenda Dunbar Rutten (Renaissance Naples 1) 68.2. <i>Winged Migration: Departing the World of ALEPH Web Course Reserves and Finding a Home in the GUI</i> • Christopher Rose, Jerrie Bayer (Renaissance Naples 1)
		69. <i>Current and Future Needs for Data Interchange and Integration</i> • Ellen Bishop, Joshua Greben (Renaissance Corsican)
	DigiTool	70. <i>DigiTool Update</i> • Tomer Paz, Ex Libris (Renaissance Sienna)
	DPS	71. <i>Digital Preservation System Update</i> , Yaniv Levi, Ex Libris (Renaissance San Marco)
	General	72. <i>The Ex Libris Open Platform</i> • Tamar Sadeh, Ex Libris (Renaissance Sicilian A)
	MetaLib	73.1. <i>Getting Subject Librarians Onboard with MetaLib</i> • Jean Rainwater (Renaissance Capri)
		73.2. <i>Trends and Patterns of MetaLib Usage at a Large Academic Library</i> • Frank Cervone (Renaissance Capri)
	Primo	74.1. <i>Implementing Primo at the University of Iowa Libraries</i> • Brian Thompson, Sue Julich (Renaissance Naples 2)
		74.2. <i>Primo Rules!</i> • Glenn Manino (Renaissance Naples 2)
	SFX/ Verde	75.1 <i>Using SFX and MARCIt to Add E-journal Holdings to a Millenium Catalog</i> • John Wenzler, Ya Wang (Renaissance Sicilian B)
		75.2. <i>It Works: Integration of SFX into a Statewide Virtual Library</i> • Kaie Gohn (Renaissance Sicilian B)
		76.1. <i>A & I TO A-to-Z: Expanding Verde/SFX</i> • Marc Lalonde, Amaz Taufique (Renaissance Naples 3) 76.2. <i>Achieving a Superb SFX Menu without Changing the Ex Libris Code</i> • Peggy Kain, Jesse Cross (Renaissance Naples 3)
	Special Interest Groups	77. <i>ALEPH Cataloging/Authorities Special Interest Group</i> • Steve Thomas, Chair (Westin Shanghai)
		78. <i>ALEPH Systems and Reports Special Interest Group</i> • Mike Rogers, Chair (Westin Tokyo)
79. <i>Voyager Acquisitions Special Interest Group</i> • Julia McGinnis, Chair (Westin Barcelona)		
80. <i>Voyager Call Slip Special Interest Group</i> • Emily Batista, Chair (Westin Vancouver)		
		81. <i>Voyager Technical/System Administration Special Interest Group</i> • Bob Trotter, Chair (Westin Centennial Ballroom Salon D)

8:30-10:00am	Voyager	82. <i>Web Services Approach to a ShelfLister Inventory</i> • Ken Herold (Westin Melbourne) 83. <i>Let VRS Work for You!</i> • Kelly Robinson (Westin Casablanca)	
10:00-10:30am	Break		
10:00-11:00am	<i>SFX Demo</i> • Ex Libris (Westin Centennial Ballroom Foyer)		
10:30-11:30am	ALEPH	84. <i>Invoices: From ALEPH to PeopleSoft (and Back Again)</i> • Heather Hessel, Erik Biever (Renaissance Corsican) 85. <i>Extending the OPAC: Integrating WorldCat, Maps, and More into ALEPH</i> • Mark Dehmow, Aaron Bales (Renaissance Naples 1) 86. <i>Global Changes in ALEPH: An Overview</i> • Sandy Card (Renaissance Sienna) 87. <i>Battles and Triumphs with Online and Batch Inventory: ALEPH Version 17 and Higher - Inventory Management</i> • Peg Lawrence, Bruce Willms, Mary Ann Greenwald (Westin Naples) 88. <i>ALEPH Report Options on the Fly</i> • Sherri Parker (Renaissance Sicilian A) 89. <i>How to Give Your Headings a Bath: Description of an Authorities Clean-up Project</i> • Mike Rogers (Renaissance Sicilian B)	
		DigiTool	90. <i>Building New Hampshire History</i> • Eleta Exline (Westin Vancouver)
		General	91. <i>Periodical Management Using Algorithm Budgeting Method</i> • Azungwe Kwembe (Westin Shanghai)
		MetaLib	92. <i>MetaLib Update</i> • Karen Groves, Ex Libris (Renaissance Naples 2)
		SFX	93.1. <i>Databases in SFX: MIT's Experience</i> • Rich Wenger (Renaissance Naples 3) 93.2. <i>Umlaut: An Open Source Link Resolver Front End</i> • Jonathan Rochkind (Renaissance Naples 3) 94. <i>OpenURL Server Recognition without Maintaining a Database and without Browser Extensions</i> • Sue Dentinger, Rose Smith (Renaissance Capri)
	Special Interest Groups		95. <i>ALEPH ILL Special Interest Group</i> • Scott Schmucker, Chair (Westin Marina 4th Floor) 96. <i>All Product EDI Special Interest Group</i> • Christine Moulen, Chair (Westin Tokyo) 97. <i>Voyager Cataloging Special Interest Group</i> • Marilou Hinchcliff, Chair (Westin Casablanca) 98. <i>Voyager Circulation/Reserve Special Interest Group</i> • Krista Higham, Chair (Westin Melbourne)
			Verde
		Voyager	100. <i>Integrating Selection and Ordering in Voyager: WorldCat Selection</i> • Janet Lute, Katharine Treptow Farrell (Westin Barcelona) 101. <i>From Order to Check Out: Improving Workflows through Acquisitions, Cataloging, and Circulation</i> • Jackie Wrosch (Westin Centennial Ballroom Salon D)
	<i>Primo Demo</i> • Ex Libris (Westin Centennial Ballroom Foyer)		
	11:00am-12:00pm	<i>Primo Demo</i> • Ex Libris (Westin Centennial Ballroom Foyer)	
	12:00-1:30pm	Lunch including ELUNA Business Meeting and Conference Wrap-up (Renaissance Ballroom)	
	2:00-3:30pm	ALEPH	102.1. <i>A Diversity of Data: Adventures in Automated ALEPH Batch Loading of Vendor MARC Records</i> • Pascal Calarco, Mark Dehmow (Renaissance Capri) 102.2. <i>Discussion of the Workflow of Batch Loading Bibliographic Records into ALEPH -- Does the Current Workflow Match Our Needs?</i> • Karen Newbery, Beth Brennan (Renaissance Capri) 103.1. <i>Not on Shelf? Click Here</i> • Kathy Williams (Renaissance Corsican) 103.2. <i>Extreme Makeover, Web OPAC Edition</i> • Amy Helfman (Renaissance Corsican) 104. <i>Perl DBI Scripting for ALEPH</i> • Christine Moulen, John Osborn (Renaissance Sicilian A)
SFX/ MetaLib			105.1. <i>The Encore Experience: Using a Third Party Discovery Tool with ALEPH and Voyager</i> • Tari Keller, Alesia McManus (Renaissance Naples 2) 105.2. <i>Using ALEPH and Endeca to Develop a User Interface at Duke University</i> • Gwyneth Duncan, Ken Mitchel (Renaissance Naples 2) 105.3. <i>Designing and Implementing an Endeca and ALEPH-based Library Catalog in Florida</i> • Joshua Gregen, Jean Moises, Ned Stewart (Renaissance Naples 2)
			106.1. <i>XML-based Subject Guides: Pulling It All Together</i> • Susan Tschabrun, Mike Blyleven (Renaissance Naples 3) 106.2. <i>Building an RSS Table of Contents Alerting Service Using SFX and MetaLib</i> • David Walker (Renaissance Naples 3)

2:00-3:30pm	Special Interest Groups	107. <i>ALEPH Reserve Special Interest Group</i> • Jennifer J. Kuntz, Christopher Rose, Co-chairs (Westin Shanghai)
		108. <i>ALEPH X Server Special Interest Group</i> • Greg Lee, Chair (Westin Tokyo)
		109. <i>Voyager Serials Special Interest Group</i> • Sherrie Kristin, Chair (Westin Barcelona)
		110. <i>Voyager Universal Borrowing Special Interest Group</i> • Bruce Gottschall, Chair (Westin Naples)
	Verde	111. <i>Verde - Back to the Future! Lightening Reports and Discussion Forum</i> • Rich Wenger, Moderator; Laura Mors; Heather Tunender; Rob Van Rennes; Kathy Varjabedian; Rich Wenger (Renaissance Naples 1)
Voyager	112. <i>Crushing, Blending, and Stretching Data: Data Warehousing and Mining Data from Voyager and Other Library and University Systems for Assessment of Library Operations</i> • Ray Schwartz (Westin Centennial Ballroom Salon D)	
	113. <i>Cat for Acq, Acq for Cat, and CatAcq for OPAC</i> • Julia McGinnis (Westin Casablanca)	
	114.1. <i>Periodical Holdings Going in New Directions: Checking, Changing, and Cleaning Serial Holdings in a Physical Reorganization Project</i> • Ted Schwitzner, Sandra K. Roe (Westin Melbourne) 114.2. <i>Complex Publication Patterns Theory and Practice</i> • Ted Schwitzner, Alexis Rogers (Westin Melbourne)	
3:30pm	Conclusion of Conference — Thank You for Participating!	

ELUNA Steering Committee, 2007-2008

Christina Meyer, Chair	University of Minnesota
Janet Lute, Vice-chair/Chair-elect, Liaison to SFX Group	Princeton University
Margery Tibbetts, Past-chair, Liaison to Verde Group	California Digital Library
Janet Higgins, Secretary	Idaho State University
Suzanne Julich, Treasurer	University of Iowa
Pascal Calarco, Liaison to DigiTool Group	University of Notre Dame
James Corey, Liaison to ALEPH Group	Florida Center for Library Automation
Edward Corrado, Liaison to Regional Users Groups	State University of New York - Binghamton
Dale Flecker, Liaison to IGeLU	Harvard University
Wil Frost, Chair, Conference Planning Committee	University of Hawaii at Manoa
Weiling Liu, Liaison to MetaLib Group	University of Louisville
Bob Trotter, Liaison to Voyager Group	University System of Georgia

Acknowledgements

ELUNA membership fees and conference registration fees provide major support for the conference. ELUNA thanks Ex Libris North America for sponsoring the conference reception and the keynote speaker, as well as providing valuable staff assistance. ELUNA thanks Sun Microsystems for sponsoring selected conference expenses.



POWERED BY



Maps and Floor Plans

The Aquarium of the Pacific is about a 15-minute walk down Pine Avenue or the nearby pedestrian promenade from the Renaissance or The Westin. You may also ride the free Passport C line (red bus) that runs along Ocean Boulevard and down Pine Avenue toward the Aquarium and waterfront restaurants.

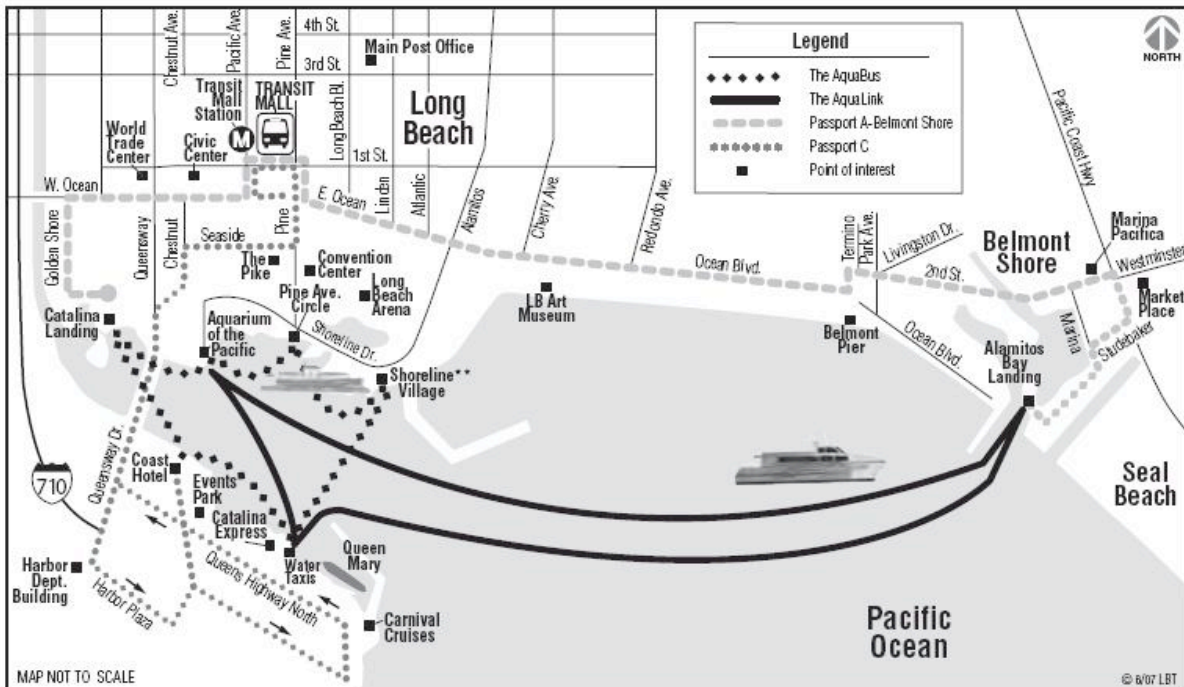
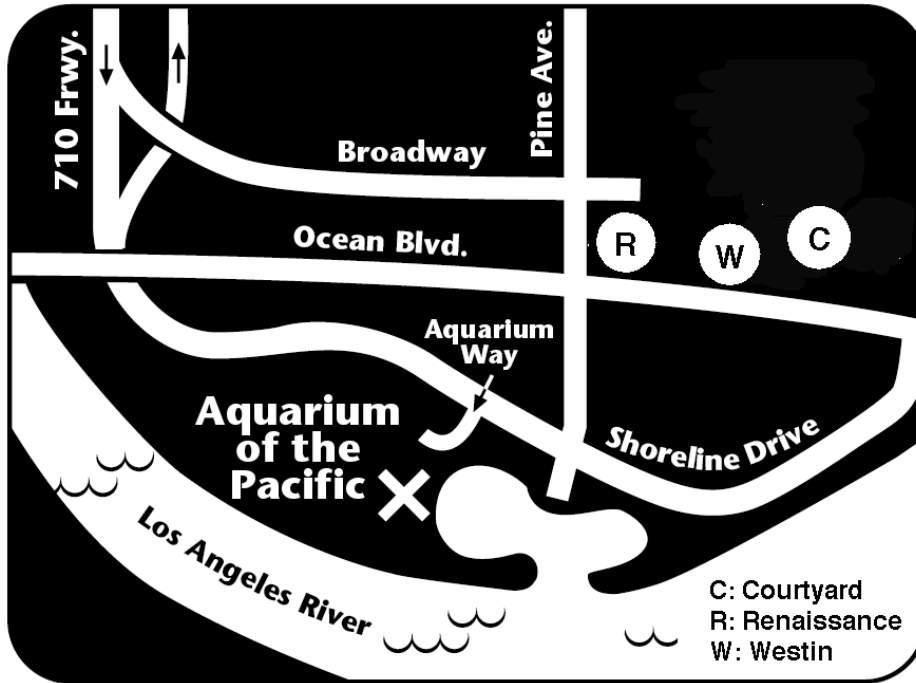

Renaissance Long Beach Meeting Rooms • 2nd and 3rd Floors

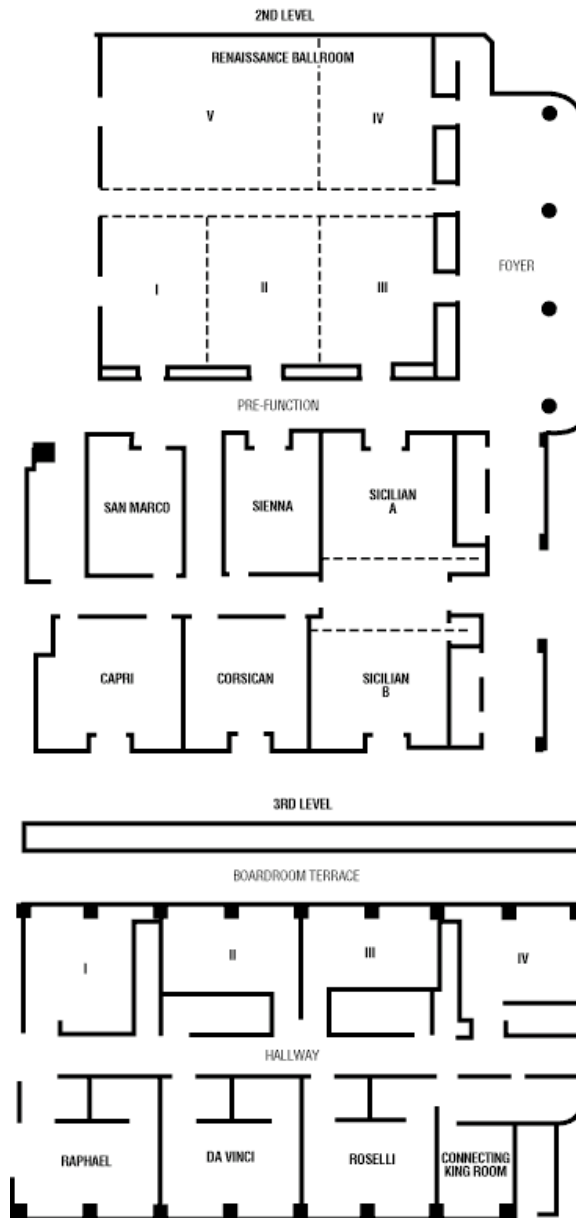

1ST LEVEL

The Naples 1, 2 & 3 meeting rooms are around the corner from Starbucks

The Westin Long Beach Meeting Rooms • 1st, 2nd, 3rd, 4th Floors

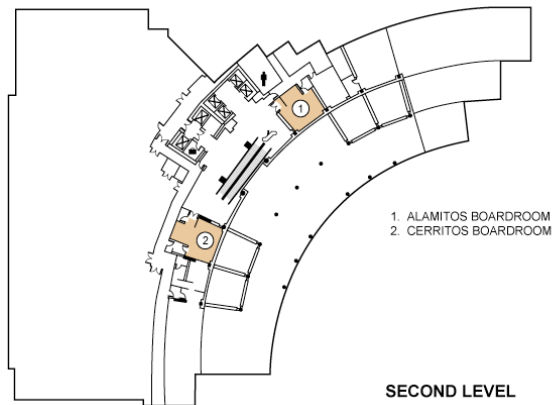
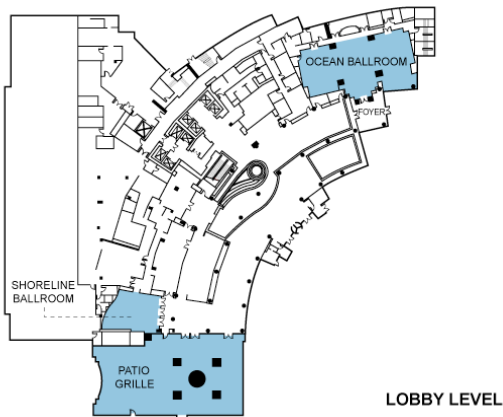
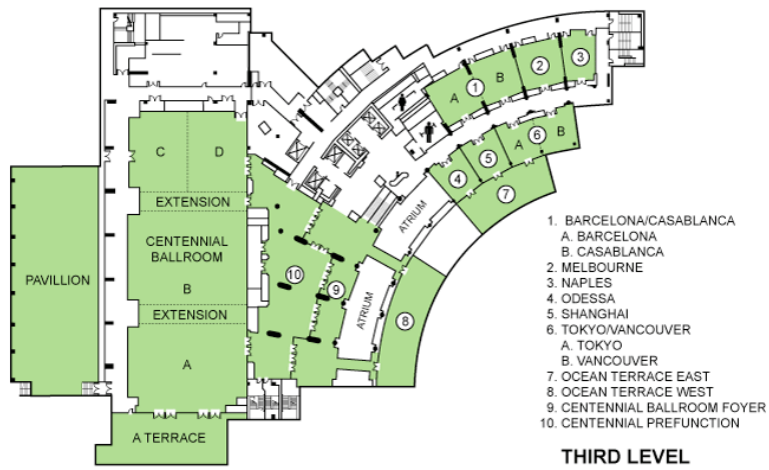
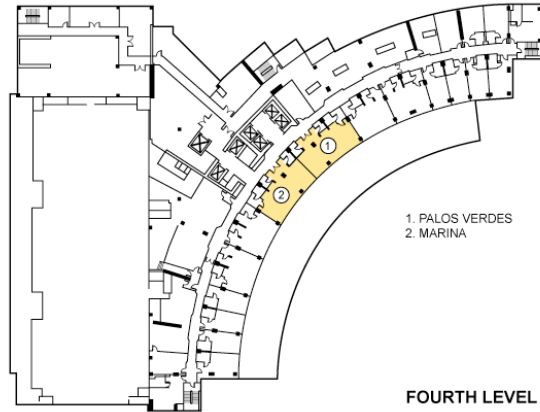

See you at ELUNA 2009 in Richmond, Virginia, May 3-7, 2009